

Remington®

SPIRIT™ PCP

AIR RIFLE OWNER'S MANUAL

ALWAYS FOLLOW THESE SAFETY WARNINGS

⚠ WARNING: Not a toy. This air rifle is intended for ADULT USE ONLY. Misuse or careless use may cause serious injury or death.

⚠ WARNING: DO NOT brandish or display this air rifle in public --- it may confuse police and others thinking it is a firearm. DO NOT change the coloration and markings to make it look more like a firearm. That is dangerous and may be crime.

⚠ WARNING: WHATEVER THE CONDITION IS, NEVER POINT THIS AIR RIFLE AT ANYONE EVER.

⚠ WARNING: Lead pellets. Do not inhale dust or put pellets in mouth. Wash hands after handling. This product contains lead, a chemical known to public to cause cancer and birth defects (or other productive harm).

⚠ WARNING: Use only compressed air in this air rifle. Use no other gases --- including oxygen, which can cause a fire or explosion that may result in serious injury or death.

⚠ WARNING: This air rifle could fire when dropped or jarred, with or without the safety engaged.

R

**Thank you for choosing Remington® Spirit™ PCP
Play safety with all our PCP airguns.**

PLEASE READ ALL INSTRUCTIONS AND WARNINGS IN THIS MANUAL BEFORE HANDLING OR SHOOTING THIS AIR RIFLE. ALWAYS USE CAUTION WHEN OPERATING THIS AIR RIFLE. BUYER AND USER SHOULD HAVE THE DUTY TO OBEY ALL LAWS ABOUT THE USE AND OWNERSHIP OF THIS AIR RIFLE. AND REMEMBER THIS AIR RIFLE IS HIGHLY POWERED AND INTENDED FOR ADULT USE ONLY.

⚠ WARNING: Not a toy. This air rifle is intended for ADULT USE ONLY. Misuse or careless use may cause serious injury or death.

⚠ WARNING: DO NOT brandish or display this air rifle in public --- it may confuse police and others thinking it is a firearm. DO NOT change the coloration and markings to make it look more like a firearm. That is dangerous and may be crime.

⚠ WARNING: WHATEVER THE CONDITION IS, NEVER POINT THIS AIR RIFLE AT ANYONE EVER.

⚠ WARNING: Lead pellets. Do not inhale dust or put pellets in mouth. Wash hands after handling. This product contains lead, a chemical known to public to cause cancer and birth defects (or other productive harm).

⚠ WARNING: Use only compressed air in this air rifle. Use no other gases --- including oxygen, which can cause a fire or explosion that may result in serious injury or death.

⚠ WARNING: This air rifle could fire when dropped or jarred, with or without the safety engaged.

⚠ CAUTION

Failure to follow the instructions and recommendations in this owner's manual may result in bodily injury including face, eye, and ear injury, blindness, or deafness.

Before using your new air rifle check if it is fully charged and abide the below basic safety rules:

1. Treat every rifle as it is loaded.
2. Never point the rifle at anyone, or allow anyone to point a rifle at you, even if you know it is not loaded.
3. Always carry the rifle so that the direction of the muzzle is under control, even if you stumble.
4. Always be sure of your target and what lies behind it before firing your rifle.
5. Never leave a loaded rifle unattended.
6. It is recommended that eye & ear protection is worn when charging the cylinder and shooting.
7. You and others with you MUST always wear shooting glasses to protect your eyes. If you wear reading glasses the lenses must be certified for impact resistance or you should wear safety glasses intended for use over normal optical reading glasses.
8. Always keep your finger off the trigger and out of the trigger guard until ready to shoot.
9. Never look down the muzzle of an air gun.
10. Always keep the air gun "ON SAFE" until you are ready to shoot.
11. Always check to see if the airgun is "ON SAFE" and unloaded when getting it from another person or from storage.
12. Do not shoot at fragile objects such as windows.
13. Do not attempt to disassemble or tamper with your air gun, Unauthorized repairs or modifying the function of your air gun in any way may be unsafe and will void your warranty.
14. Before storing your air gun, make sure it is unloaded and the arrow gun is "ON SAFE".

The Remington® Spirit™ PCP rifles are easy to operate, consistent, and can provide trouble free use if the provided instructions are adhered to. A few minutes spent reading this manual are essential for safe operation and will increase the many years of pleasure you will derive from this fine airgun.

SAFETY RULES

- Always treat the gun as if it is loaded
- Always point in a safe direction
- Always check to see if the gun is empty before handling
- Always wear protection goggles – both shooters and spectators
- Always keep the safety engaged until you are ready to shoot and pointing the rifle in a safe direction
- Always keep your finger away from the trigger area until you are ready and it is safe to shoot.
- Always ensure you have a clear and safe shooting background
- Always use the correct ammunition

- Never point the gun at anyone or at anything at which you do not intend to shoot
- Never store your gun loaded
- Never store the gun with ammunition
- Never fire your gun at hard objects as ricochets can occur
- Never allow others to use or inspect your gun without first instructing them the fundamentals of safe use – for safety protection always stress keeping the muzzle pointing in a safe direction at all times.
- Never adjust the trigger pressure
- Never re-use ammunition

P35 IS A SINGLE & MULTI SHOT, PRE-CHARGED, MANUAL LOADING PCP RIFLE.

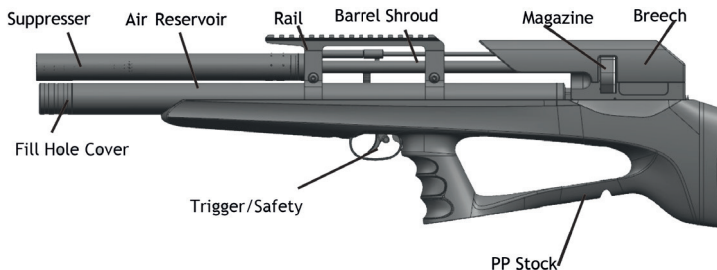

LOADING PELLETS

Magazine-Filling Procedure:

- Turn the magazine counterclockwise to the end and fasten it by hand. (see Step 1)
- Put the pellet into the magazine according to the pointed-end direction in Step 2. the magazine is full. (see Step 3 & Step 4)

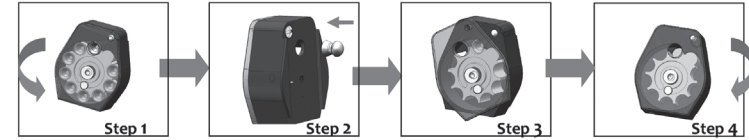

- Check the air pressure in your gas cylinder is in a reasonable range.
- Point muzzle in a SAFE DIRECTION when loading. NEVER POINT IT AT ANYONE.
- Make sure safety is “ON” before loading.

THE LOADING PROCEDURE:

- When you are holding the air rifle, make sure it is not cocked and unloaded and check if you take the same caliber pellet as your barrel (see Step 5).
- Pull the bolt backward to cock the rifle (The bolt cannot automatically return forward). Now the loading port can be seen in Step 6.
- Align the magazine bugle into breech slot and assemble the magazine (see Step 6).
- Push bolt forward to the end (see Step 7).
- After shooting out all pellets, pull the bolt to the end, dismantle the magazine and reload.

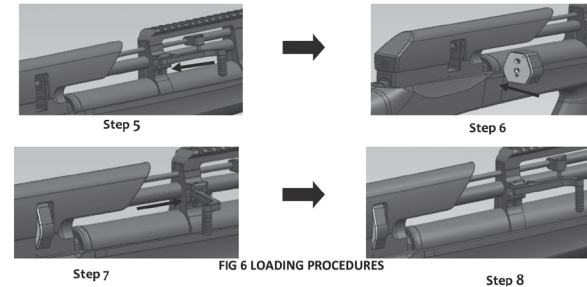
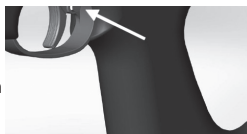

FIG 6 LOADING PROCEDURES

FILLING THE RIFLE

Fit the attached fill adaptor to the socket coupler of your charging equipment, which must incorporate a pressure gauge (See FIG 3 to fit fill adaptor).



RE POSITION

Remove fill hole cover first. Ensure both fill adaptor and the filler hole are clean from dirt, then insert fill adaptor into filler hole (See FIG 4 to insert fill adaptor).

We recommend you fill 24MPa pressure to the gas cylinder.

FILLING THE AIR RIFLE WITH A HAND PUMP

- Be sure to wear eye protection.
- Make sure the air rifle is unloaded and not cocked.
- Read all instructions with your hand pump so you are familiar with its operation.
- Put the air rifle "ON SAFE" (see FIG 1)
- Point the air rifle in a SAFE DIRECTION.
- Follow the Step 1 and Step 2, now you are ready to fill pressure.

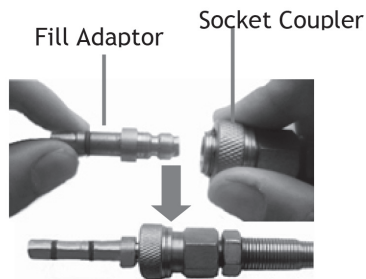

FIG 3 FIT FILL ADAPTOR



FILLING THE AIR RIFLE WITH A HIGH PRESSURE TANK

- Follow the FIG 3 to fit the fill adaptor.
- Then follow FIG 4 to insert fill adaptor to your rifle.
- Slowly open the valve on your tank and start filling the air rifle SLOWLY. Filling too quickly will cause heat buildup that can affect the accuracy of the fill pressure.
- Watch the gauge on your air rifle and the scuba tank until the reasonable pressure is reached.
- DO NOT EXCEED ITS MAXIMUM PRESSURE 25MPa/250Bar.
- Turn the valve on your tank off when the reasonable pressure is reached.
- BLEED RESIDUAL air in fill hose COMPLETELY to avoid hose whip and possible injury.
- Disconnect fill adaptor from fill hole on the air rifle.

DEPRESSURIZING THE AIR RIFLE

Your P35 air rifle, like most PCP air guns, is best stored with some pressure in the reservoir. This keeps seals in the air rifle forced against the sealing surface and saves some air for next time fill or use. In the event you want or need to depressurize the air rifle follow the dry fire method.

- Bleed all the air by repeatedly cocking and dry-firing with the air rifle pointed in a SAFE DIRECTION until pressure gauge on your air rifle shows ZERO and air cannot be heard when the shot is fired.
- Put the air rifle "ON SAFE".

NOTE: BEFORE YOU REMOVE THE FILL ADAPTOR FROM THE FILLER HOLE, TURN ON THE EXHAUST VALVE ON YOUR FILLING EQUIPMENT AND MAKE SURE THE HOSE HAS ALREADY EXHAUSTED. THEN TURN OFF THE EXHAUST VALVE.

THE AIR RESERVOIR ON YOUR P35 AIR RIFLE IS NOT REPLACEABLE. DO NOT INTEND TO DISMANTLE ANY PARTS ON YOUR AIR RIFLE IN ANY SITUATION.

IF YOU COULDN'T FILL IN AIR WHEN RESERVOIR IS COMPLETELY EMPTY (OR AT ZERO PRESSURE), TRY COCKING THE BOLT AND DRY FIRE ONCE WITH MUZZLE POINTED IN A SAFE DIRECTION.

ALWAYS MAKE CERTAIN THE AIR RIFLE IS NOT LOADED AND THERE IS NO PELLET IN THE CHAMBER WITH THE SAFETY "ON" WHEN FILLING.

MANUAL SAFETY

- Safety button can be set to “ON” and “OFF”
- The SAFE position is when safety is in the BACK position.
Push IN safety, see the arrow direction in FIG 1. In this position, the gun cannot be fired.
- The FIRE position is when safety is in the FORWARD position. Push OUT safety, see the arrow direction in FIG 2. In this position, the gun is ready to shoot.

CAUTION: UNTIL YOU ARE ACTUALLY READY TO FIRE, KEEP THE SAFETY IN “ON” POSITION FOR SAFETY CONCERN.

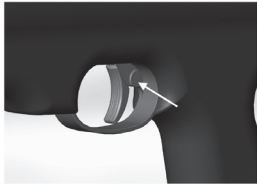

FIG 1 SAFE POSITION

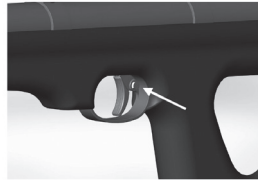

FIG 2 FIRE POSITION

MAINTENANCE

Lubricating and Cleaning

Every 3 months or 1000 shots apply mineral based oils sparingly to the following parts:

- The surface of valve pin
- The seal of loading port

It is recommended to clean the barrel with a cleaning rod every 3 months or every 1000 shots.

Never lubricate inside the barrel.

Before you begin oiling or cleaning your air gun, always check to make sure it is unloaded.

Always be sure your air gun barrel is clean and not blocked.

After cleaning ensure that no cleaning patch or other obstruction remains in the barrel.

Annually, take your air gun to a gunsmith even if it seems to be working well, since some issues in your air gun may not be apparent from external examination.

Take your air gun to a gunsmith if water, sand, etc. enters the internal mechanism of the air gun, for complete cleaning.

Dangerous conditions may occur if you do not keep your air gun clean and working properly.

Quick Fill Adaptor Seal Replacement

After a period of time, the fill adaptor seals will need to be replaced. The need for this will become noticeable if air is heard leaking at fill adaptor or the adaptor ejected from pistol fill hole when charging. Always ensure to replace both seals.

Intake Valve O-Ring Replacement

After a period of time, the intake valve seal will need to be replaced. Once air is heard leaking from intake valve, it is the sign of immediate replacement of the intake valve seal.

- Make sure there's no residual high pressures air in air reservoir, and wait until gauge needle points ZERO.
- The followings are replacement procedures of intake valve seal.

Dismantle the intake valve.

Remove intake valve screw and the used seal, and replace it and re-assemble.

- Make sure all the threads are screwed in during the assembly.
- It is recommended to seek a competent gunsmith for help to replace seal.
If you need to replace it yourself, make sure all the threads are screwed in during the assembly.
- It is recommended to seek a competent gunsmith for help to replace seal.
If you need to replace it yourself, make sure there's no high pressure in the air reservoir and the gauge needle has pointed to zero.

Shooting your Airgun Safely

Unless it is necessary for uncocking an unloaded airgun, as referenced above, **DO NOT SHOOT A PCP AIRGUN WITHOUT A PELLET!**

To do so permits the piston to slam hard against the front of the compression chamber. Repeated “dry firing” can damage your airgun.

Shoot your airgun shortly after cocking and loading. Do not leave the airgun cocked for extended periods of time.

1. Always keep the muzzle pointed in a safe direction.
2. Load the airgun. See “Loading your Airgun” section of this manual.
3. Point the muzzle at your intended target.
4. Disengage the safety mechanism by moving the safety to the “Fire” position.
5. Acquire the target.
6. Discharge the airgun by pulling the trigger when ready.

Which Pellets To Use?

The all important ingredient to airgun shooting success:

You need several different kinds.

Airgun pellets, just like firearm ammunition, are available in a great variety of weights and shapes to suit particular shooting needs. The following will help you select the type of pellets that will work best for you. Keep in mind that each air rifle and air pistol is an individual and it requires some experimentation on your part to find just exactly the types of pellets that will work best for each of your particular airguns.

The quality of the pellets that you shoot in your airguns will determine the success you have on the target range or in the field. It is essential to shoot only high quality pellets in spring airguns. Low quality or deformed pellets not only result in poor accuracy but can actually damage these airguns by allowing compressed air to blow by the pellet and cause the piston to slam harshly against the forward end of the compression chamber.

Always use proper pellets. Use only high quality pellets to avoid harmful oils, abrasive material and airgun wrenching air blow-by. Precision adult airguns are intended for use only with precision airgun pellets; steel shot or darts are not recommended and generally damage rifled bores and may cause dangerous ricochet or rebound. Properly seated pellets should not show rub marks on rear of skirt when breech is reopened prior to firing. Damaged, used, or unauthorized projectiles may be unsafe.

REPAIR/SERVICE

IF YOUR AIR RIFLE REQUIRES A REPAIR OR SERVICE, PLEASE CONTACT THE DEALER WHO YOU PURCHASED THE RIFLE FROM AND THEY WILL ARRANGE ACCORDINGLY.

WARRANTY:

COVERED:

MANUFACTURING / MATERIAL FAULTS AND LABOUR ON GENUINE FAILURE – RETURN CARRIAGE COST EXCEPTED.

NOT COVERED:

UNAUTHORISED DISASSEMBLY.

FAULTS OR PROBLEMS RESULTING FROM USE OF INCORRECT AMMO. COMMERCIAL USE INVALIDATES THE WARRANTY.



WARNING! This airgun is classified as an adult gun and is recommended for adult use only. This airgun is exempt from specific types of trigger pull, safety mechanisms and drop test requirements. This airgun may discharge if dropped. Misuse or careless handling of the airgun may result in property damage, personal injury and/or death.

Safety Measures & Warnings

- * This air gun will shoot if cocked, loaded, safety disengaged and trigger pulled.
- * Air guns are not toys. Never let young children use an air gun unsupervised.
Adult supervision is strictly required during use. Misuse or careless use may cause serious injury or death.
- * Learn how your air gun operates and safe gun handling procedures before loading and using it.
- * Always use eye & hearing protection and make bystanders use the same. Failure to do so may result in eye injuries and permanent hearing loss.
- * Do not point at anything you do not intend to shoot even though the gun is unloaded.
Always keep the gun pointed in a safe direction.
- * Never pull a gun toward you by the muzzle.
- * Before you shoot, consider where the pellet will travel should you miss your intended target, thus ensuring no damage or harm could result.
- * Be sure of your target before you pull the trigger. Never shoot at sounds.
- * When shooting, always have a safe shooting range, that is; have a safe area for shooting, a safe distance between you and the target, and a safe backstop to trap the pellets and hold the target.
- * Do not shoot at a target, which allows ricochets or deflections.
- * Do not shoot into or at water.
- * Do not shoot at or near power lines or insulators. Be especially careful in wooded areas where power lines may not be as visible.
- * Do not load the air gun until you are ready to shoot.
- * Always keep your fingers away from the trigger & muzzle during cocking and handling.
- * Do not walk, run or jump when carrying a loaded or cocked air gun. A loaded or a cocked air gun should never be carried inside a vehicle, house, camp or public place. Never climb a tree or fence or jump a ditch with a loaded air gun. In such a case, first unload it and hand the gun to a friend or place it on the ground on the other side of the obstacle before crossing yourself.
- * When transporting the air gun, keep it unloaded and 'on safe'.
- * Always keep the air gun 'on safe' until you are ready to shoot even if the air gun is unloaded.
- * Do not put the air gun away loaded and unattended.
- * Always check to see if the air gun is 'on safe' and unloaded when getting it from another person or from storage.
- * Always keep the air gun and/or pellets out of the reach of children.
- * Keep the air gun and pellets in separate places, better if under lock and key.
- * Do not attempt to disassemble or tamper with your air gun. Use a competent gunsmith.
Many air guns contain powerful CO2s which can cause serious injury if released in an uncontrolled manner.
- * Always handle and treat your air gun as though it were loaded.
- * Improper use or handling of air guns is not the responsibility of the manufacturer or distributor, under any circumstances. The user is responsible for any harm, which may be caused.
- * Think first, shoot second.
- * Don't rely on any mechanical safety. Half safe is not safe.
- * Be safe not sorry.
- * Respect other's property.
- * Air guns should never be used under the influences of alcohol or drugs.



OFFICIAL UK DISTRIBUTOR OF REMINGTON® AIRGUNS & ACCESSORIES

SERVING THE GUN, FISHING TACKLE, TOY & SPORTS TRADES FOR OVER 50 YEARS

Commerce Way, Whitehall Road Industrial Estate, Colchester, Essex CO2 8HH

Tel: 01206 795333 Fax: 01206 792679 www.sportsmk.co.uk sales@sportsmk.co.uk