

# CZ P-10 C 6mm

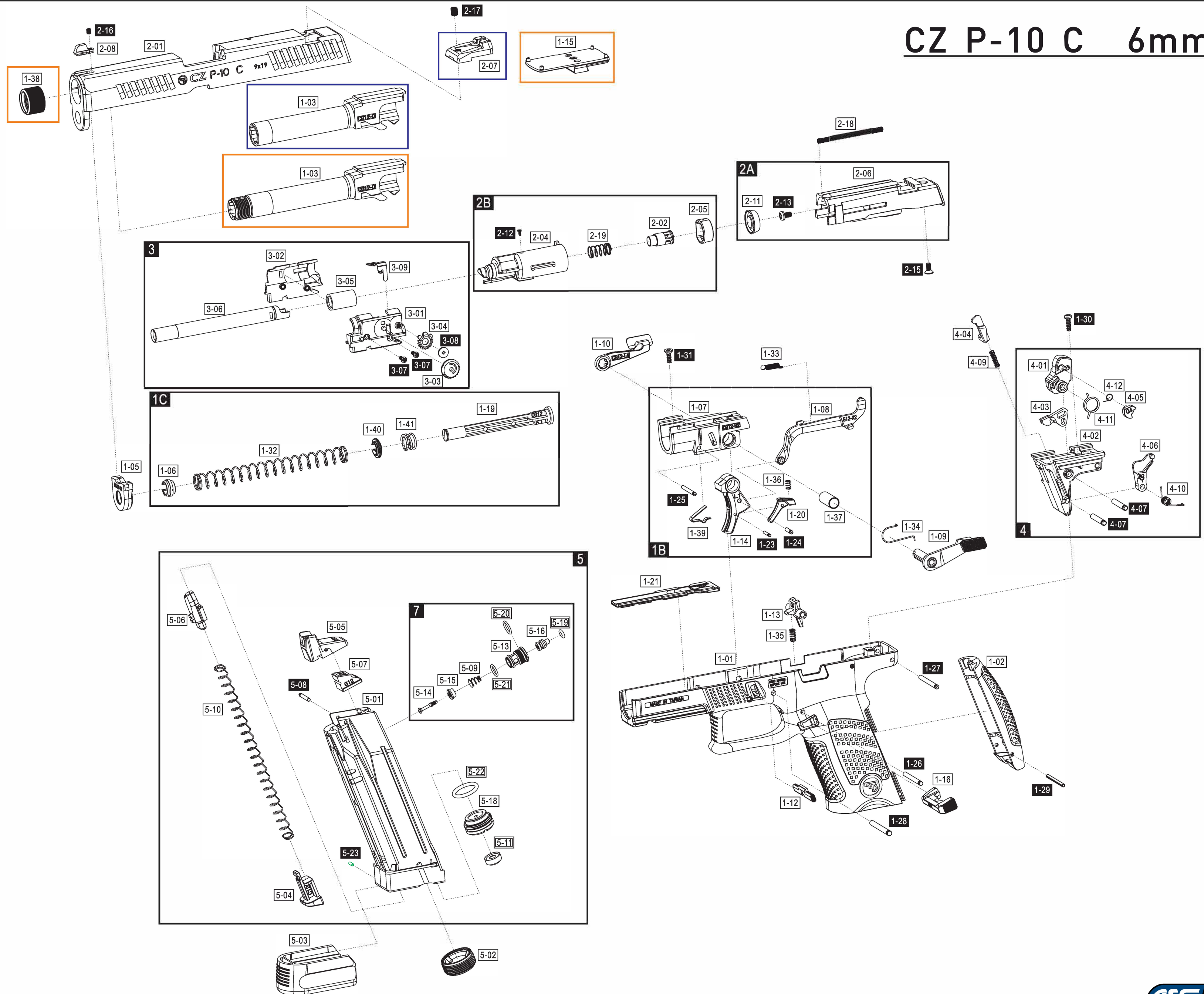

## Part list - Pistol CBB, PL, MS, CZ P-10 C

PARTS NO.	DESCRIPTION	PARTS NO.	DESCRIPTION
1-01	FRAME(BLACK)	<b>2A</b>	<b>PISTON SEAT COMBINATION</b>
	FRAME(SAND)	2-06	PISTON SEAT
1-02	BACK GRIP COVER	2-11	PISTON RUBBER
1-03	OUTER BARREL	2-13	SCREW 3x5
	OUTER BARREL(THREAD)(BLACK)	<b>2B</b>	<b>PISTON FIXED SEAT COMBINATIO</b>
	OUTER BARREL(THREAD)(ORANGE)	2-02	REGULATING VALVE
1-05	RECOIL SPRING GUIDE SEAL	2-04	CHAMBER
1-09	SLIDE STOP ( L )	2-05	REGULATING VALVE SEAT
1-10	SLIDE STOP ( R )	2-12	SCREW 1.4x3
1-12	SAFETY RIVET	2-19	REGULATING VALVE SPRING
1-13	MAG. CATCH PARTS	<b>3</b>	<b>BARREL SEAT COMBINATION</b>
1-15	MOUNT FOR RED DOT	3-01	BARREL SEAT ( L )
1-16	MAG. CATCH	3-02	BARREL SEAT ( R )
1-21	SAFETY	3-03	HOP UP ADJUSTABLE
1-26	AXIS 2.5x25.5	3-04	HOP UP ADJUSTABLE PARTS
1-27	AXIS 2.5x27	3-05	BB HOLDER
1-28	AXIS 3x28	3-06	INTERNAL BARREL
1-29	SPRING PIN 2x25	3-07	SCREW 2x5
1-30	SCREW 2.6x8	3-08	SCREW 2.5x3
1-31	SCREW 2.6x8	3-09	HOP UP ADJUSTABLE PARTS
1-33	TRIGGER CONNECTOR SPRING	<b>4</b>	<b>HAMMER SEAT COMBINATION</b>
1-34	SLIDE STOP SPRING	4-01	HAMMER
1-35	MAG. CATCH PARTS SPRING	4-02	HAMMER SEAT
1-38	MUZZLE FIXING(BLACK)	4-03	FIRING PIN
	MUZZLE FIXING(ORANGE)	4-05	HAMMER WHEEL
2-01	SLIDE	4-06	HAMMER RELEASE
2-07	SIGHT SEAT	4-07	AXIS 3x19
2-08	FRONT FIGHT	4-10	HAMMER RELEASE SPRING
2-15	SCREW 2.6x6	4-11	HAMMER SPRING
2-16	SCREW 2.5x3	4-12	HAMMER WHEEL SPRING
2-17	SCREW 4x5	<b>5</b>	<b>MAGAZINE COMBINATION</b>
2-18	PISTON SEAT SPRING	5-01	MAG. BODY
4-04	FIRING PIN CONTROLLER	5-04	MAG. BASE CATCH
4-09	FIRING PIN CONTROLLER SPRING	5-05	RUBBER SEAT
5-02	PIERCING LEVEL SCREW	5-06	BB FOLLOWER
5-03	MAG. BASE	5-07	RUBBER
<b>1B</b>	<b>TRIGGER SEAT COMBINATION</b>	5-08	AXIS 2x13.4
1-07	TRIGGER SEAT	5-10	MAG. SPRING
1-08	TRIGGER CONNECTOR	5-11	PIERCER SEAL
1-14	TRIGGER	5-18	PIERCER

1-20	TRIGGER BUTTON	5-22	O-RING 13x2
1-23	AXIS 1.5x9	5-23	AXIS 1.5x5
1-24	AXIS 2x9	<b>7</b>	<b>MAG. VALVE COMBINATION</b>
1-25	AXIS 2x20	5-09	VALVE SPRING
1-36	TRIGGER BUTTON SPRING	5-13	MAG. VALVE
1-37	COPPER AXIS 7x6x15.45	5-14	MAG. VALVE PARTS
1-39	SAFETY PIECE	5-15	VALVE SEAL
<b>1C</b>	<b>RECOIL SPRING GUIDE COMBINATIC</b>	5-16	VALVE COVER
1-06	RECOIL SPRING GUIDE STOPPER	5-19	O-RING 2.7x1.45
1-19	RECOIL SPRING GUIDE	5-20	O-RING 7x1.0
1-32	RECOIL SPRING	5-21	O-RING 6x1.0
1-40	RECOIL SPRING GUIDE SEAL		
1-41	RECOIL SPRING GUIDE SEAL SPRING		