

IMPORTANT! PLEASE READ BEFORE HANDLING YOUR AIR RIFLE

Remington®

VOUGHT™

AIR RIFLE OWNER'S MANUAL



IMPORTANT!

This manual contains operating, care and maintenance instructions. To assure safe operation, any user of this airgun must read and understand this manual before using the airgun. Failure to follow the instructions and heed the warnings in this manual can cause property damage, personal injury, and/or death.

This manual should always accompany this airgun, and be transferred with it upon change of ownership.

AIRGUN PELLETS



WARNING—This airgun is not a toy. This airgun is designated for use by experienced adult shooters, ages 18 and older. This airgun is intended for match, competition and/or range shooting. Misuse or careless handling of the airgun may result in property damage, personal injury and/or death.

KEY FACTS: The Vought™ Air Rifles (i) are MANUFACTURED for Sportsmarketing™ SMK™, Commerce Way, Whitehall Road Industrial Estate, Colchester, Essex, UK CO2 8HH; (ii) is design to only shoot .177 (4.5mm) / .22 (5.5mm) calibre AIRGUN PELLETS ONLY; (iii) shoots projectiles for .177 at velocities of 800 feet per second or for .22 at velocities of 600 feet per second when used with the recommended ammunition and in accordance with the enclosed operating instructions.

	Vought™ (.177)	Vought™ (.22)
MUZZLE VELOCITY	800 fps*	600 fps*
MAX. DISTANCE	500 yds (457 m)	500 yds (457 m)

*pellet weight dependent

Ten Rules of Airgun Safety:

1. Always keep the muzzle pointed in a safe direction.
2. Airguns should be unloaded when not in use.
3. Don't rely on your airgun's safety.
4. Be sure of your target and what's beyond it.
5. Use proper projectiles and propellants.
6. If your airgun fails to fire, handle with care.
7. Always wear eye and ear protection when shooting.
8. Be sure the barrel is clear of obstructions.
9. Don't alter or modify your airgun.
10. Learn the mechanics and handling characteristics of your airgun.

⚠ WARNING: This airgun is classified as an adult gun and is recommended for adult use only. This airgun is exempt from specific types of trigger pull, safety mechanisms and drop test requirements. This airgun may discharge if dropped. Misuse or careless handling of the airgun may result in property damage, personal injury and/or death.

⚠ WARNING: Use of improper projectiles may cause property damage, personal injury and/or death.

⚠ WARNING: Reuse of projectiles may cause property damage, personal injury and/or death.

⚠ WARNING: Modification of the airgun mechanism may cause a airgun to malfunction and tampering with an airgun may make it unsafe to use and cause property damage, personal injury and/or death.

⚠ WARNING: Do not brandish or display an airgun in public. Police and others may mistake the airgun for a firearm. Public display of an airgun may break local laws and/or regulations.

⚠ WARNING: Do not change the coloration and marking of this airgun to make it look more like a firearm. Altering the aesthetics of an airgun to be more firearm like may break local laws and/or regulations.

⚠ WARNING: If the performance of your airgun changes, have it inspected and repaired by an authorized repair center. Use of an airgun in need of repair may cause property damage, personal injury and/or death.

⚠ WARNING: All repairs to your airgun should be made by an authorized repair center. Improper repairs and/or maintenance of an airgun may cause property damage, personal injury and/or death.

⚠ WARNING: Inspect your airgun for proper function after each use, and if the airgun has been dropped or abused in any manner. Use of an airgun in need of repair and/or maintenance of an airgun may cause property damage, personal injury and/or death.

Contents of this Manual

4. How to charge your airgun
 - Filling your airgun
5. Depressurizing your Airgun
6. Manual safety
6. Loading your Airgun
6. Shooting your Airgun Safely
7. Which Pellets To Use?
7. Telescopic Sight



UP TO
12
FTLB

.177 UP TO
800
FT PER SEC
WITH HIGH ENERGY
LEAD PELLETT

.22 UP TO
600
FT PER SEC
WITH HIGH ENERGY
LEAD PELLETT

PRE
CHARGED
PNEUMATIC

MULTI SHOT

MANUAL
SAFETY

THREADED
SOUND SUPPRESSOR

Statement of Non-Liability

Remington assumes no liability for this airgun's resale, handling, use or possession under local laws or regulations. Remington will honour no claims that may result from careless handling, unauthorized adjustments, defective or improper ammunition, corrosion or neglect.

The Remington® Vought™ bolt action pcp air rifles are easy to operate, consistent, and can provide trouble free use if the provided instructions are adhered to. A few minutes spent reading this manual are essential to safe operation and will increase the many years of pleasure you will derive from this fine airgun.

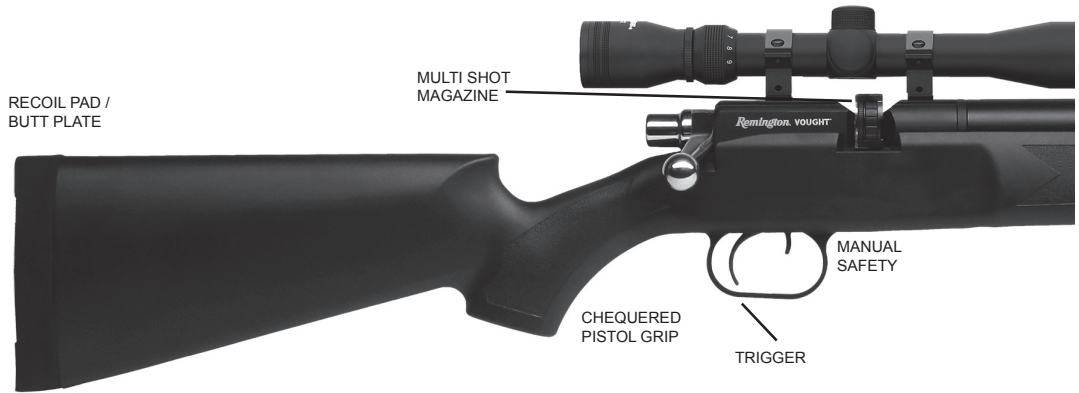

CHARGING THE RIFLE

Fit the filler nozzle to the air-line of the charging equipment, which must incorporate a pressure gauge. Ensure both filler nozzle and the rifle filler are clean from dirt, then push the nozzle on the filler hole. We recommended your fill 19mpa/190bar pressure to the air reservoir. Do not exceed the maximum pressure 20mpa/200bar.

PRESSURING (FILLING) THE AIR RIFLE FROM A HAND PUMP

- Be sure to wear eye protection
- Make sure the air rifle is unloaded and not cocked.
- Read all the instructions with your hand pump so you are familiar with its operation
- Put the air rifle 'ON SAFE'
- Point the air rifle in a safe direction
- Follow the step 1 and step 2, now you are ready to fill pressure.

PRESSURING (FILLING) THE AIR RIFLE FROM A HIGH PRESSURE TANK

- Follow the Step 1 to fit the filler nozzle
- Then follow Step 2.
- Slowly open the valve on your tank and start filling your air rifle SLOWLY. Filling too quick will cause heat build up that can affect the accuracy of the fill pressure.
- Watch the gauge on your air file and the air reservoir until the reasonable pressure is reached.
- DO NOT fill the air rifle to more than 20mpa/200bar.
- Turn the valve on your tank off when the reasonable pressure is reached.
- BLEED the fill hose COMPLETELY to avoid hose whip and possible injury.
- Disconnect the tank's fill hose from the filler nozzle on the air rifle.

These features reflect the more sophisticated requirements of precision adult airgun shooting. These non-powder guns are intended for use by experienced adult shooters who understand their proper and safe use.

WARNING! Keep your hands and other objects away from the trigger and safety during the cocking and loading procedure. This airgun will discharge when it is cocked, the safety is in the "Fire" position, and the trigger is pulled. An uncontrolled discharge of an airgun can cause property damage, personal injury and/or death.

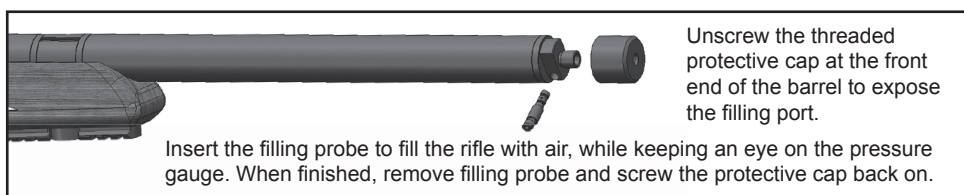
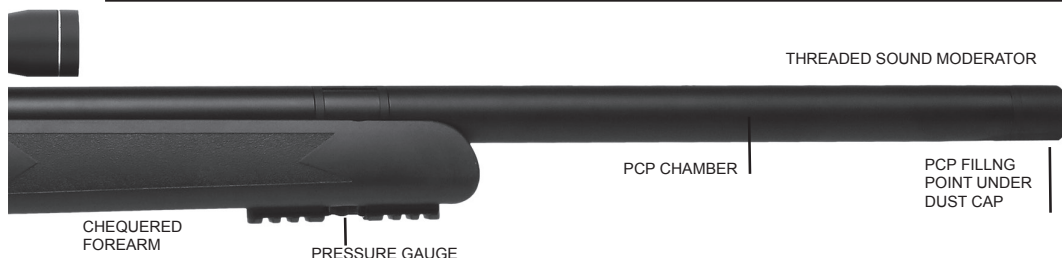

Insert the filling probe to fill the rifle with air, while keeping an eye on the pressure gauge. When finished, remove filling probe and screw the protective cap back on.

DEPRESSURIZING THE AIR RIFLE.

Your Vought™ air rifle, like most PCP rifles, is best stored with some pressure in the reservoir. This keeps the seal in the air forced against the sealing surface and saves some air for next time fill or use. In the event you want or need to depressurize the air rifle follow the next steps.

- Using the dry firing method
- Keep the air rifle pointed in a safe direction
- Remove all the air from the air rifle by repeatedly cocking and dry-firing with the air rifle pointed in a safe direction until the pressure gauge on your air rifle shows no pressure and air cannot be heard when the shot is fired.
- Put the air rifle "ON SAFE"

FILLING NOTES

Before you remove the filler nozzle from the filler hole, turn on the exhaust valve on your filling equipment and make sure the hose has already exhausted. Then turn off the exhaust valve.

The air reservoir on your Vought air rifle is not replaceable. **DO NOT INTEND TO DISMANTLE ANY PARTS OF YOUR AIR RIFLE IN ANY SITUATION.**

If your air rifle is being filled from completely empty (zero pressure) the tension of the hammer pressing against the valve may keep the valve open which will cause air to leak down the barrel. In the event this occurs try cocking the bolt and leaving it in the rear (fully open) position to eliminate the force on the valve allowing it to close. Always make certain the air rifle is not loaded and there is not a pellet in the chamber with the safety "ON".

Manual Safety

- Safety button can be set to “ON” and “OFF”.
- To set the safety to “ON” push in safety lever back towards the trigger, the gun cannot be fired.
- To set the safety to “OFF” push in safety lever forward, the gun is ready to shoot.

CAUTION! Until you are actually ready to fire, keep the safety in “ON” position for safety concern.

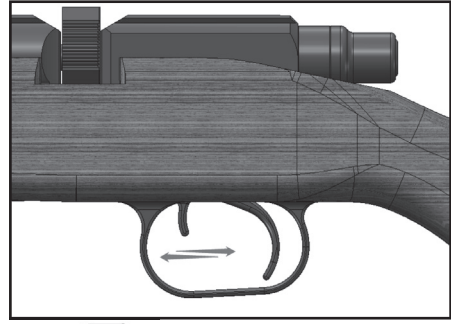

Loading Pellets

- When you are holding the air rifle. Make sure it is not cocked and unloaded and check if you take the same calibre pellet as your barrel.
- Check air pressure in your gas cylinder is in a reasonable range.
- **DO NOT POINT THE MUZZLE AT ANYONE** when loading
- Before loading, check if the safety is “ON”
- Before inserting the magazine, load pellets into the magazine hole and make sure it's centred like Step 1.
- Turn the magazine each time in the arrow direction after loading a pellet until all the holes are loaded with pellets. When your holding the air rifle, check your air rifle is set like Step 2.
- Align the magazine into the breech slot and insert the magazine. Push the bolt forward. You are now loaded.
- After shooting out all the pellets, pull the bolt back, Step 3, and remove the magazine and reload.
- Hold the air rifle stably when loading **DO NOT SHAKE OR DROP THE AIR RIFLE.**
- **KEEP YOUR FINGER AWAY FROM THE TRIGGER** when loading and turn the safety “ON”
- After loading, return the bolt to its original position in Step 4.

Step 1

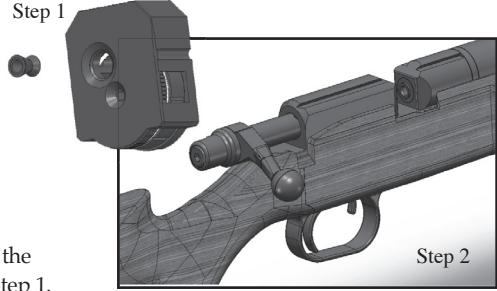

Step 2

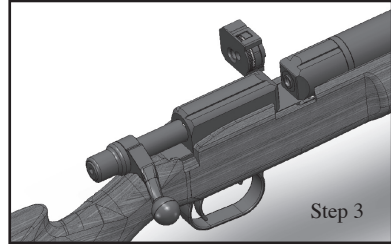

Step 3

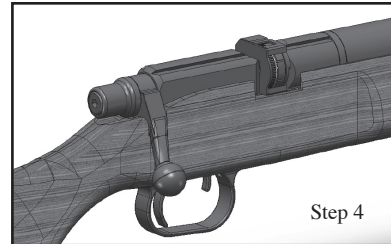

Step 4

Shooting your Airgun Safely

- Always point your air rifle in a **SAFE DIRECTION**
- Follow the instructions for loading pellets
- You and others with you should always wear shooting glasses to protect your eyes
- **DO NOT SHOOT** at hard surfaces or at the surface of water. The pellet may bounce off or ricochet and hit someone or something you had not intended to hit.
- Always choose your target carefully. It is best to shoot at a paper target that is attached to a safe backdrop. A heavy blanket should be hung behind the backstop to prevent ricochet should you miss the target.
- Your rifle is suitable for outdoor use only. Please aim at your target carefully. **THINK** about what you will hit if you miss the target.



Always be sure of your back stop. Be sure that the entire path of your pellet, even beyond the target, is safe! Do not shoot at glass or hard surfaces. Avoid ricochets. It is impossible to predict where a glancing shot will fall. Remember a pellet may travel up to about 600 yards (549 meters).



Shooting glasses are a must for all airgun shooters and spectators.

DO NOT ATTEMPT TO UNCOCK YOUR AIRGUN! If you have cocked your air rifle, loaded a pellet and decided not to take the shot in a reasonable amount of time, do not leave your airgun cocked.

- A. If already loaded: Removing the pellet is inadvisable and doing this with a sharp object could seriously damage the delicate rifling. The best course of action is to shoot the airgun into soft ground, a pellet trap or thick pile of newspapers or magazines.
- B. Always check an airgun to see if it is loaded when removed from storage or received from another person. The **ONLY** ways to be sure that your barrel is unloaded is pass a cleaning rod through the bore from the front.

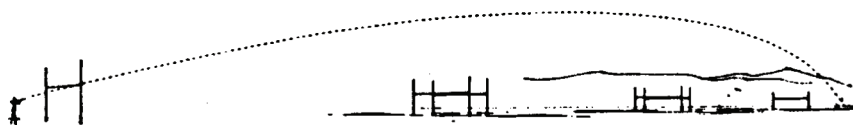

WARNING! the airguns described here are designated as Match Precision or Adult Airguns and, as such, are exempt from having a "safety" may have trigger pulls below 2 lbs. (900 gms) and may fire when dropped.

Which Pellets To Use?

Airgun pellets, just like firearm ammunition, are available in a great variety of weights and shapes to suit particular shooting needs. The following will help you select the type of pellets that will work best for you. Keep in mind that each air rifle and air pistol is an individual and it requires some experimentation on your part to find just exactly the types of pellets that will work best for each of your particular airguns.

The quality of the pellets that you shoot in your airguns will determine the success you have on the target range or in the field. It is essential to shoot

only high quality pellets in airguns. Low quality or deformed pellets not only result in poor accuracy.

Always use proper pellets. Use only high quality pellets to avoid harmful oils, abrasive material and airgun wrenching air blow-by. Precision adult airguns are intended for use only with precision airgun pellets; steel shot or darts are not recommended and generally damage rifled bores and may cause dangerous ricochet or rebound. Properly seated pellets should not show rub marks on rear of skirt when breech is reopened prior to firing. Damaged, used, or unauthorized projectiles may be unsafe.

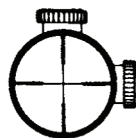
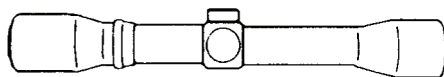

Telescopic Sight

This is the simplest and fastest to use of all since it has magnification and only one plane of focus. Also many scopes actually gather light or allow shooting when it would be too dark for iron sights. Put the crosshairs on your target and shoot. Adjust as per scope instructions. **NOTE:** Be sure that the scope that you put on your airgun is designed specifically for airgun use.

Most scope for firearms are parallax adjusted to 50 meters, where as airgun scopes are parallax adjusted to 10 meters. The scope must be factory adjusted for correct airgun range or have a properly set adjustable "Range Focus" dial at the front end of the scope tube or you will shoot inaccurately, as much as half-inch off at 25 yards (12mm at 23m).



Be a Safe Shooter!

**Read and understand this manual
before operating your airgun!**

Safety is Your Responsibility!



WARNING! This airgun is classified as an adult gun and is recommended for adult use only. This airgun is exempt from specific types of trigger pull, safety mechanisms and drop test requirements. This airgun may discharge if dropped. Misuse or careless handling of the airgun may result in property damage, personal injury and/or death.



Commerce Way, Whitehall Road Industrial Estate, Colchester, Essex CO2 8HH

Tel: 01206 795333 Fax: 01206 792679 www.sportsmk.co.uk website@sportsmk.co.uk

E&OE. COPYRIGHT© LRN @ SPORTSMARKETING SMK